

GARAGE NOTES:

FLOOR FINISH TO BE SELECTED.
 WINDOWS TO BE INSULATED LOW E/ARGON.
 (3) 2X10 HEADERS OVER ALL OPENINGS.
 5/8" GYPSUM BOARD ON ALL WALLS & CEILING
 R-21 UN-FACED INSULATION IN BETWEEN STUD CAVITIES,
 W/ 6 MIL POLY VAPOR BARRIER.
 4" CONC SLAB SEE SECTION SHEET A00
 9'X7' INSULATED OVERHEAD
 GARAGE DOOR.
 3⁰X6⁶ SELF CLOSING FIRE RATED DOOR

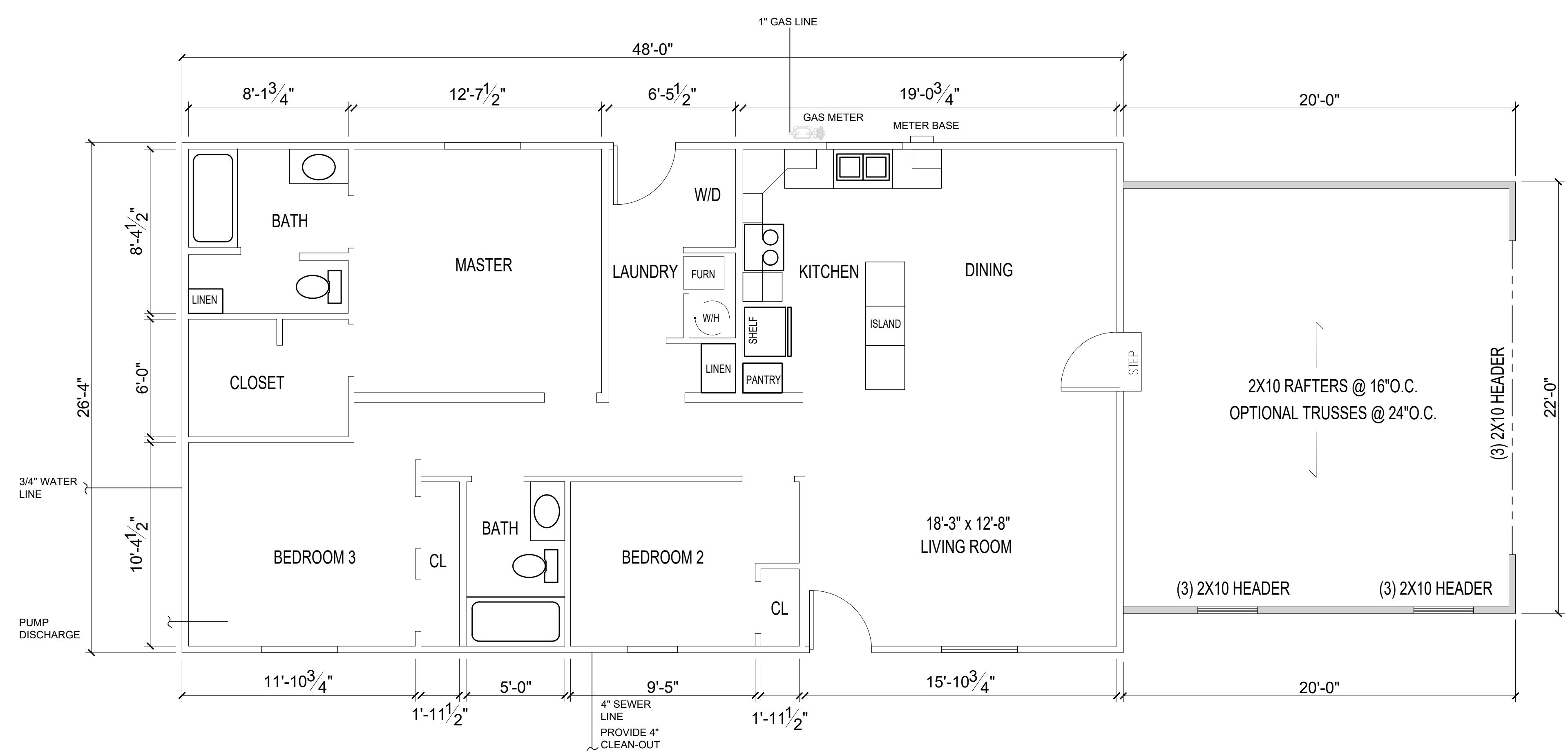

FLOOR/ 2 - CAR GARAGE PLAN
 SCALE: 1/4" = 1'-0"

DATE:	DESCRIPTION:	BY:

26'X48' ARBOR WITH GARAGE
 LOTS 101-113, 16-51
 WILLOW RUN COMMUNITY
 CRESTLINE, OHIO 44827
 JOSHUA WILLIAMS

START DATE:

STAMP:

DATE:

FILE:
2289P

PAGE CONTENT:
FLOOR PLAN
2- CAR GARAGE

DRAFTER: MIKE T. ENGINEER:

PAPER SIZE: D (24"x36") SCALE:

SHEET:
A03-2